



THE SOURCE FOR CLASSIC
LAND ROVER PARTS
www.roversnorth.com

Fitting Instructions for Series II-III Heated Windscreen Kit

Part Nr. PLK852

Fits: All Series IIA and III Negative
Earth models and all Series II
and IIA models converted to
negative earth

READ ALL INSTRUCTIONS COMPLETELY BEFORE BEGINNING!

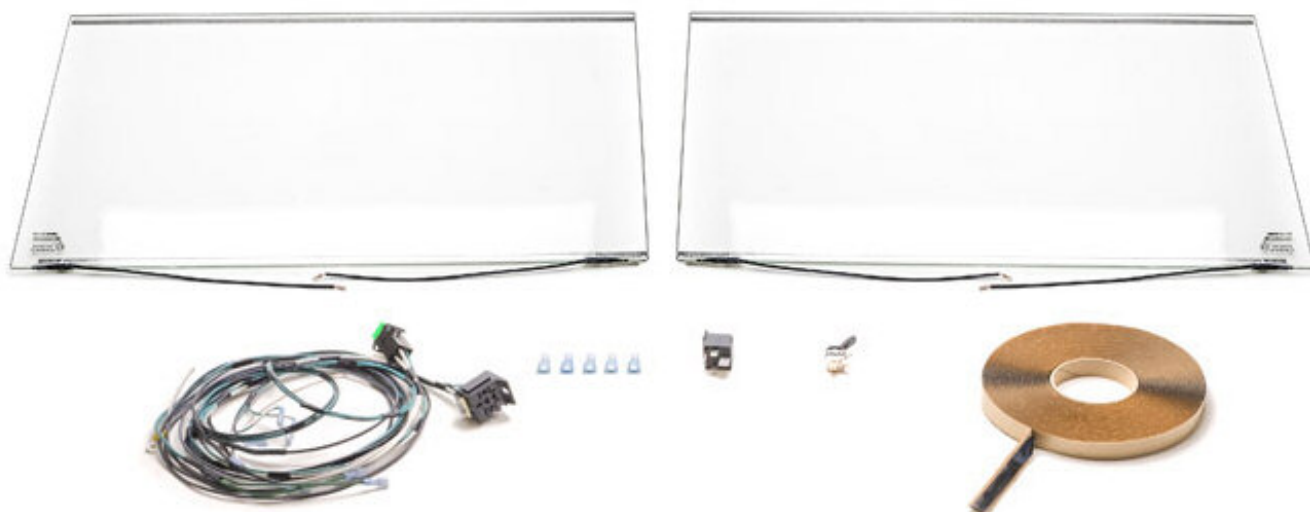

Kit includes

- 1- Windscreen Left – PLB962L
- 1- Windscreen Right– PLB962R
- 1- Wiring Harness w/ Fuses– PLQ644
- 5- Male spade connectors
- 1- Relay– 87421
- 1- Switch– RTC430
- 1- Glazing Seal – GT106

Description

Enjoy the benefits of a clear vision all winter long. Our heated windscreen will quickly clear your entire windscreen of frost and ice, long before your heater comes up to temp. contributing to safe and comfortable winter travels. Our complete kit includes 2 clear DOT Approved laminated heated windscreens, a roll of glass sealer, complete wiring harness with relay and a Genuine dash switch with wiring instructions. Compared to the original Land Rover heated windscreens, the Proline heated windscreen heating element ribbons are vertical instead of horizontal and the wires exit the bottom corners of the glass. Made in the UK.

Suggested Tools:

- Safety Glasses
- Phillips Screwdriver
- Heat Shrink Tubing
- Soldering Iron, Solder & Flux
- Wire Crimper
- Wire Stripper



Safety Glasses



Phillips
Screwdriver



Heat Shrink Tubing



Soldering Iron, Solder & Flux



Wire Crimper



Wire Stripper

Fitting Instructions for Series II-III Heated Windscreen Kit

Directions

Note: These instructions assume a 12 volt negative earth vehicle.

Step 1. Disconnect battery.

Step 2. Replace existing windscreen glass with its corresponding heated glass using the included glazing seal (see steps 3-19 below). Wires and corner cut-outs face the inside of the vehicle (see wiring diagram).

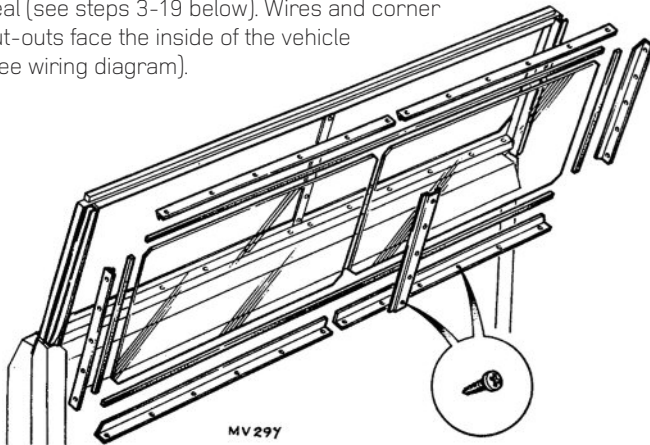

Step 3. Remove the windscreen wiper arms and blades.

Soft Top

Step 4. Remove the windscreen frame assembly.

Hard Top

Step 5. Remove the sun visors and rear view mirror from the interior of the cab.

Step 6. Remove the headlining strip from above the windscreen.

Step 7. Remove the fascia top rail. 76.46.04.

76.46.04. Hard Top – Fascia Top Rail Removing

Step 7A. Remove the screws securing the fascia top rail end cover and heater control.

Step 7B. Remove the screws securing the fascia top rail end cover (passenger side). Withdraw the end cover.

Step 7C. Remove the two nuts and bolts securing the rear of the fascia top rail to the fascia mounting plate.

Step 7D. Remove the screws securing the demise outlets. Withdraw the demise outlets.

Step 7E. Remove the screws securing the front of the fascia top rail.

Step 7F. Remove the top rail.

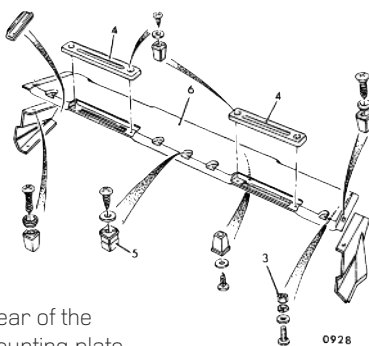

Refitting

Step 7G. Reverse instructions 1 to 6.

All Models

Step 8. Remove the screws securing the glass retaining angle strips.

Step 9. Carefully ease the glass clear of the screen.

Step 10. Remove all traces of sealant from the windscreen frame and glass retaining strips.

Refitting New Windscreen

Step 11. Line the interior of the windscreen frame with 'Glazing Seal' GT106.

Step 12. Locate the new glass in the windscreen frame and press firmly into the 'Glazing Seal'.

Step 13. Place the 'Glazing Seal' around the edges of the glass to seal the angle strips when fitted.

Step 14. Fit the angle strips to retain the glass and secure with the retaining screws.

Step 15. Remove surplus 'Glazing Sealant'.

Soft Top

Step 16. Fit the windscreen to the vehicle.

Hard top

Step 17. Fit the fascia top rail. 76.46.04.

Step 18. Fit the headlining strip.

Step 19. Fit the sun visors and rear view mirror.

Step 20. Crimp male spade connectors to windscreen wires.

Step 21. Connect the wiring harness to the heated windscreens by connecting the two black wires with female spade connectors to the wires on the outside of the heated windscreens and the two brown wires with a yellow tracer and female spade connectors to the wires on the inside of the heated windscreens. See wiring diagram.

Step 22. Connect the two green wires with female spade connectors to the toggle switch.

Step 23. Connect the white wire exiting the fuses to a positive source only powered when the ignition switch is in the ON position.

Step 24. Connect the brown wire with a yellow tracer and no end connector to a source with positive power regardless of ignition switch position. Make sure the positive power source has at least the same gauge wire as the brown wire with a yellow tracer.

Step 25. Ground the black wire with a ring terminal.

Step 26. Mount the fuse box where convenient.

Step 27. Mount relay where convenient

Step 28. Mount switch where convenient.

Step 29. Attach your wiring harness away from heat and moving objects such as brake and clutch pedal assemblies.

Step 30. Reconnect your battery and enjoy your new heated windscreen.

Fitting Instructions for Series II-III Heated Windscreen Kit

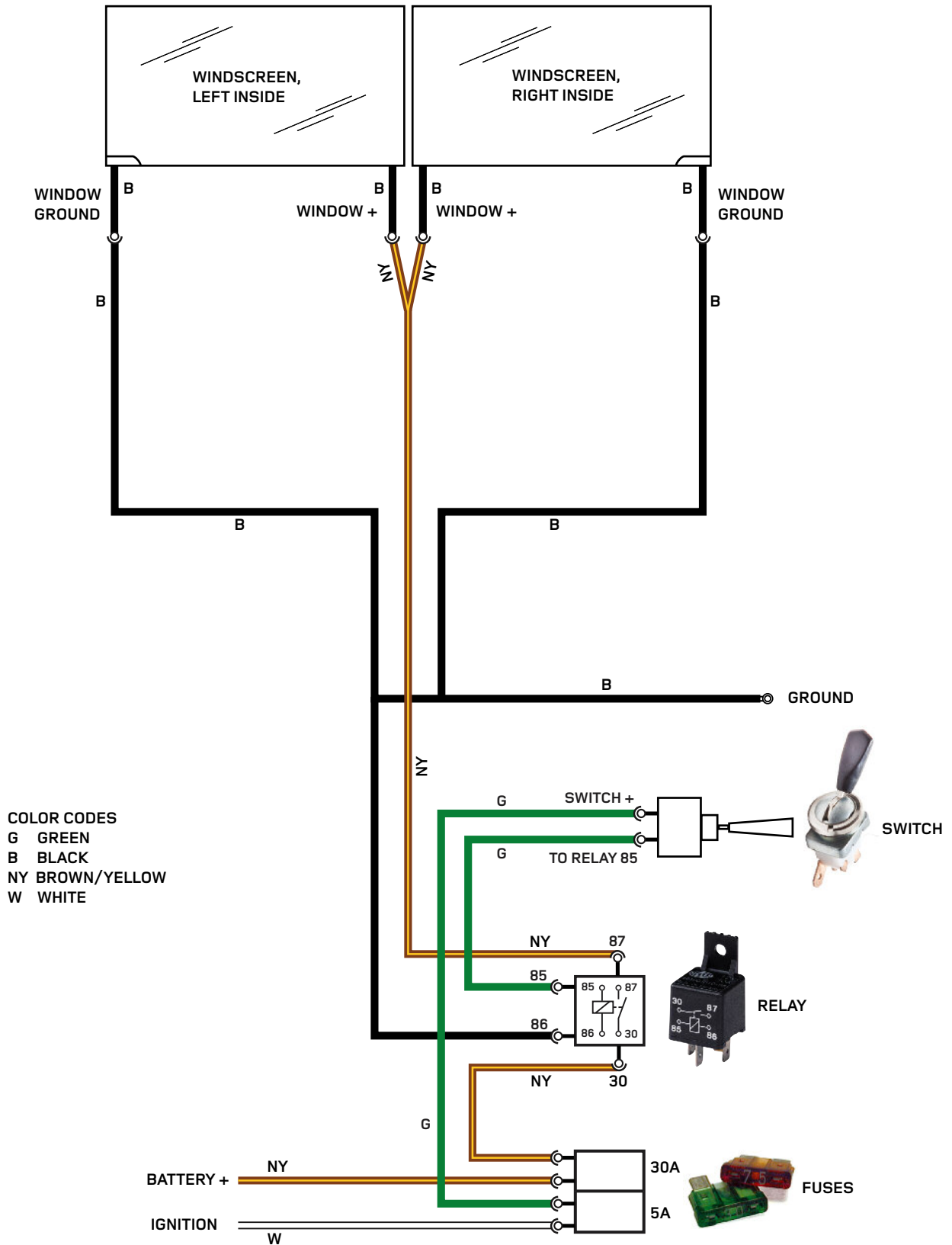

Series Heated Windscreen Wiring Harness