



THE SOURCE FOR CLASSIC
LAND ROVER PARTS

www.roversnorth.com

Fitting Instructions for Defender Front Electric Window Kit

Part Nr. RNA4664

Fits:

Defender front doors all models
2002 – 2015. Requires some
modifications to fit earlier models
1983–2001

Introduction

Easily converts front manual
wind up windows to push button
electric. Kit includes right and
left front electric window actua-
tors with motors, wiring har-
nesses, Defender dash switches,
front door blanking plugs, hard-
ware and instructions.

NOTE: This installation
instruction is for both left
and right side doors.

Suggested Tools

- Interior Trim Panel
Removal Tools
- Screwdrivers
- Sockets, Wrenches
- Soldering Iron
- Heat Gun

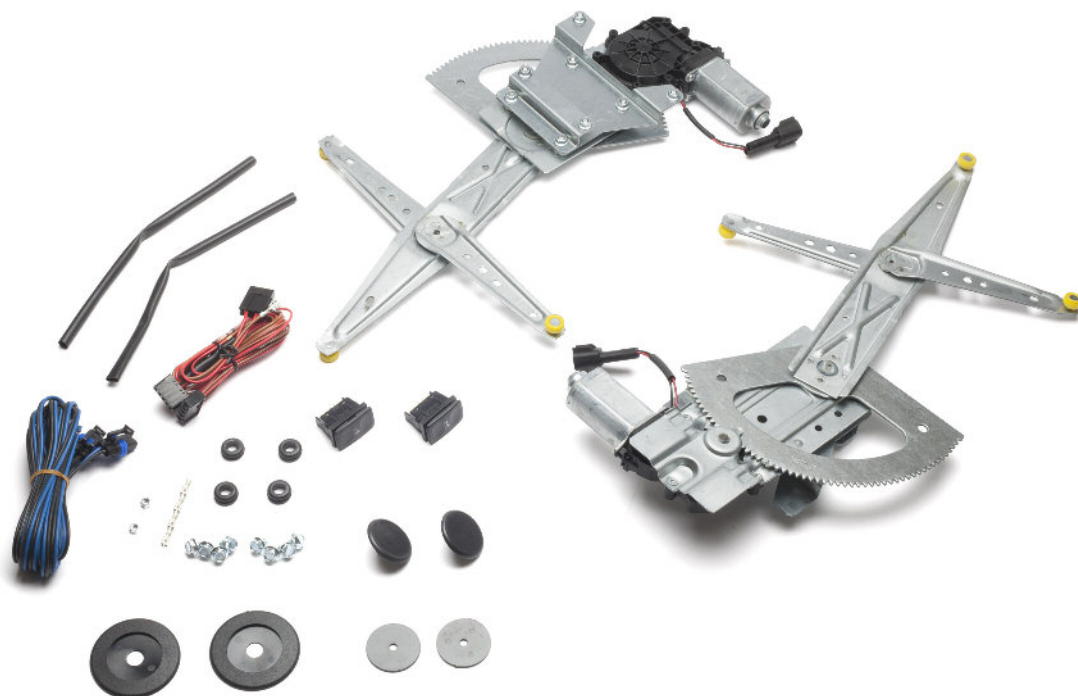

Wirecutters,
Stripper



Interior Trim Panel Removal Tools



Screwdrivers



Various Sockets,
Wrenches



Heat Gun



Soldering Iron, Solder & Flux

Fitting Instructions for Electric Window Kit Front, Defender



Advised position for the switch installation.

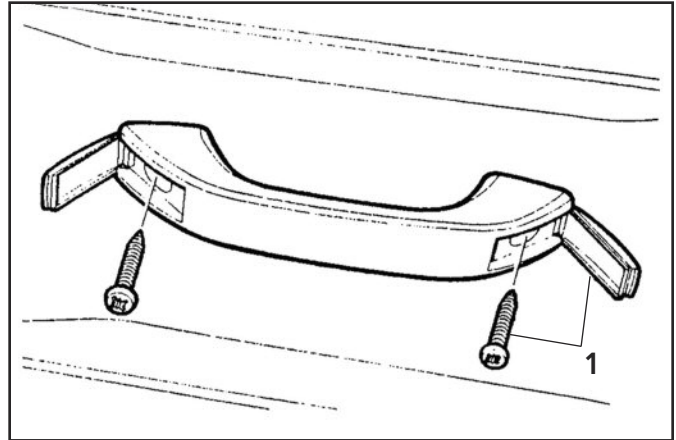

Remove door trim, steps 1-12

Step 1. Prise off the two finishers and remove the two screws securing the door pull.

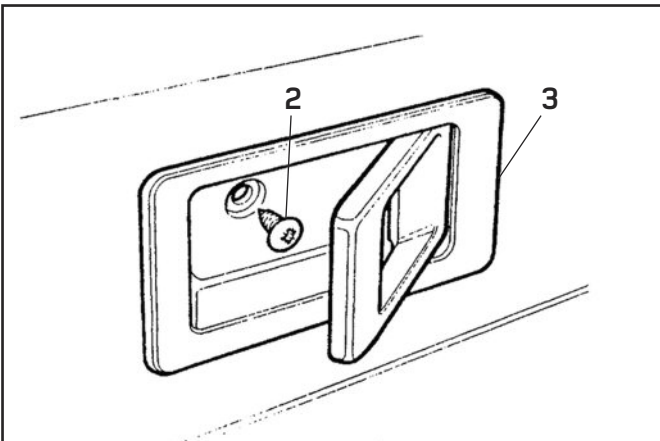

Steps 2, 3. Remove the single screw behind the remote control door handle lever. Prise off the remote control lever bezel. Use interior trim panel removal tools as necessary.

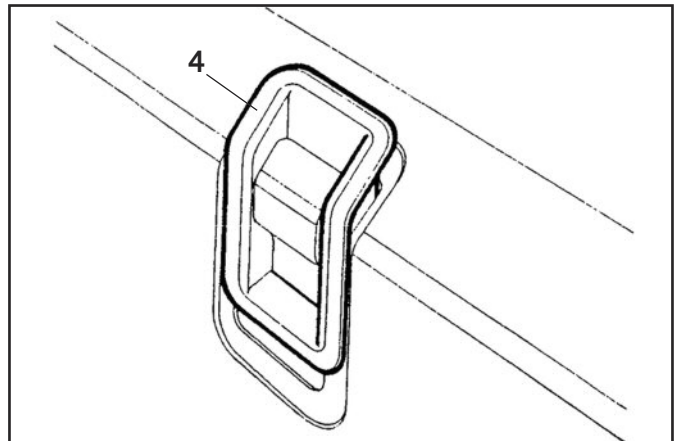

Step 4. Prise off the door locking button bezel using interior trim panel removal tools as necessary. Pay attention to not mar the surface.

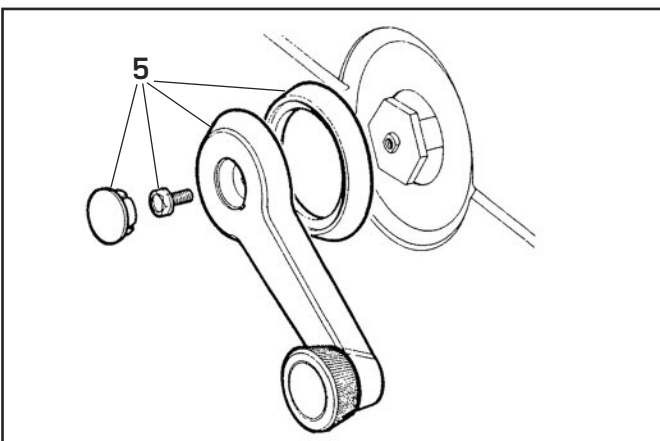

Step 5. Lever off the window regulator center finisher and remove the retaining screw and withdraw the handle and bezel. Use trim panel tools as necessary.

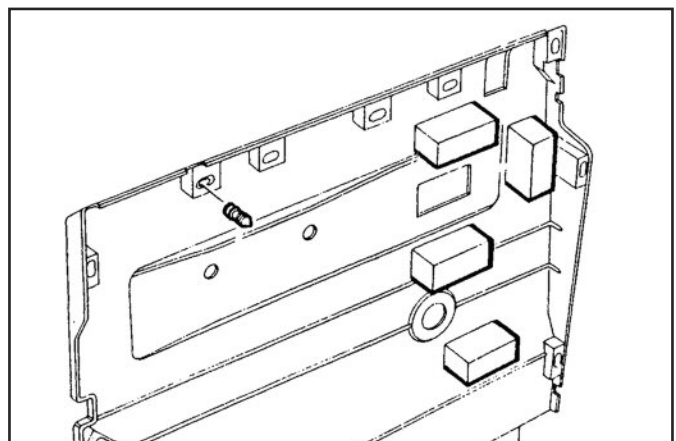

Step 6. Using a trim panel removal tool, carefully case the trim fasteners away from the door.

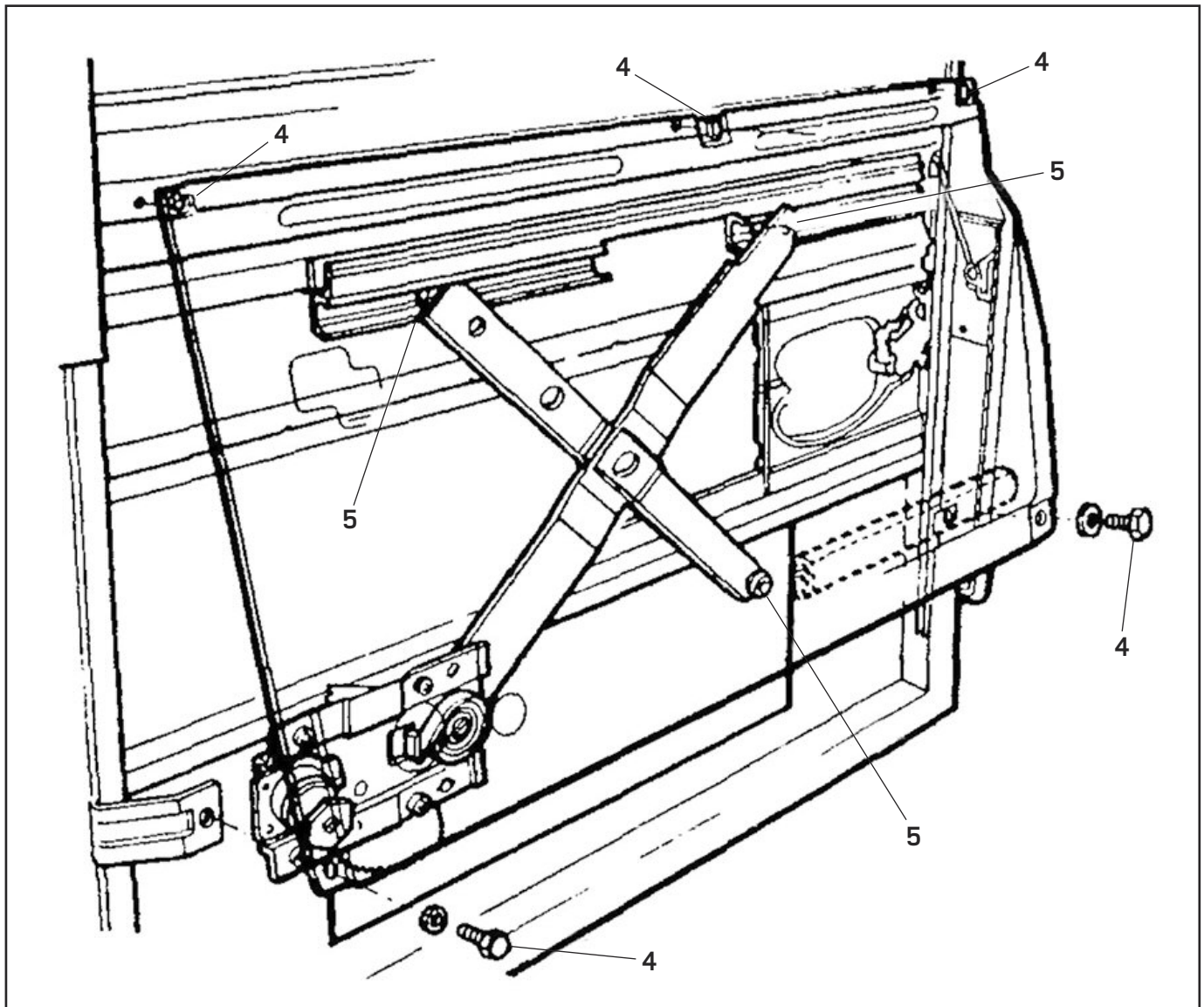
**Remove window regulator, steps 7-11**

Step 7. Remove the weather protection sheet.

Step 8. Temporarily fit the handle and position the window half open and support with a length of timber.

Step 9. Remove the two lower screws securing the mounting panel to the door and slacken the three upper screws.

Step 10. Remove the four screws retaining the window regulator to the mounting panel and slide the operating arms from the channels attached to the glass and mounting panel and remove the regulator.

Step 11. Remove the short and long channels from the window regulator (**NOTE:** Save channels to be used later).

Fitting Instructions for Electric Window Kit Front, Defender

Install new electric window regulator, steps 12–16.

Step 12. Insert the slides A, B and C into the glass channels.

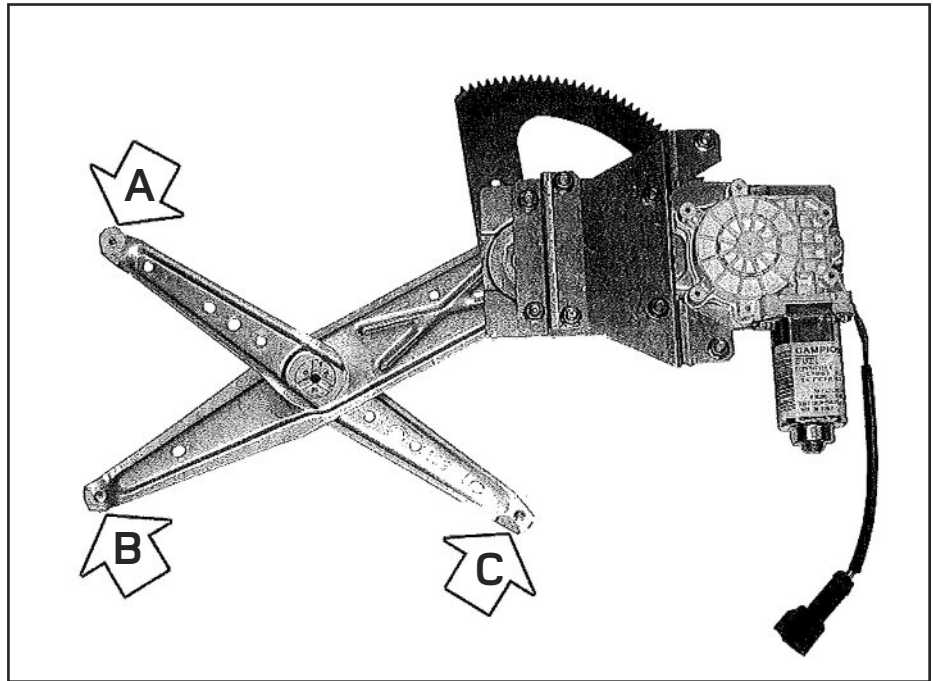

Step 13. Insert the electric window regulator into the door and secure it into the holes at positions 1, 2, 3 and 4. Secure short slide into positions 7 and 8 (see photo).

Lower the glass and secure it to the long channel into positions 5 and 6.

Step 14. Wire as per wiring diagram (see wiring diagram).

Step 15. Check correct window operation, adjust with the screws 7 and 8, if required before re-fitting door trim.

Step 16. Refit door trim per previous instructions in reverse order.

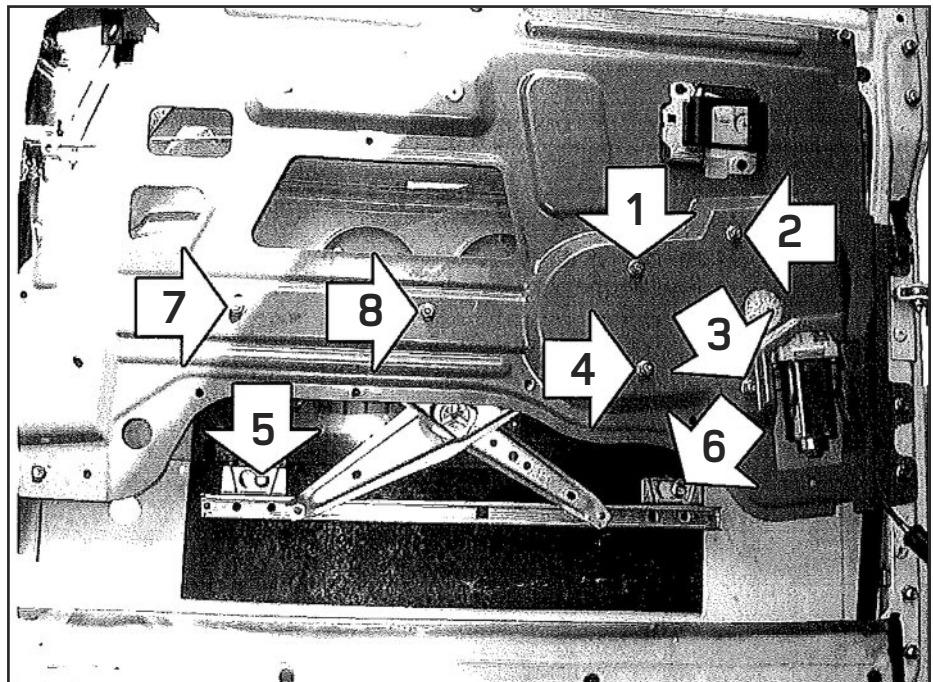

Fitting Instructions for Electric Window Kit Front, Defender

NOTE: Connect feed to +15 of ignition switch.

- Electric windows must only be operated with the ignition key turned to "ON" position.
- DO NOT leave the vehicle unattended with the ignition key still in the ignition particularly when there are children inside.
- Use caution when operating the electric windows, especially the rear windows, as back seated passengers could be carrying out actions that could be unsighted from the drivers position.
- Casual closing of an electric window could cause serious injury to a trapped limb.

CONNECT FEED TO +15 OF IGNITION SWITCH.
CONNECTER L'ALIMENTATION AU +15 APRES CONTACT.
PLUS-LEITUG +15 ANSCHLIESSEN.
CONECTAR LA CORRIENTEAL +15 BAJO CONTACTO.
COLLEGARE L'ALIMENTAZIONE AL +15 SOTTO CHIAVE.

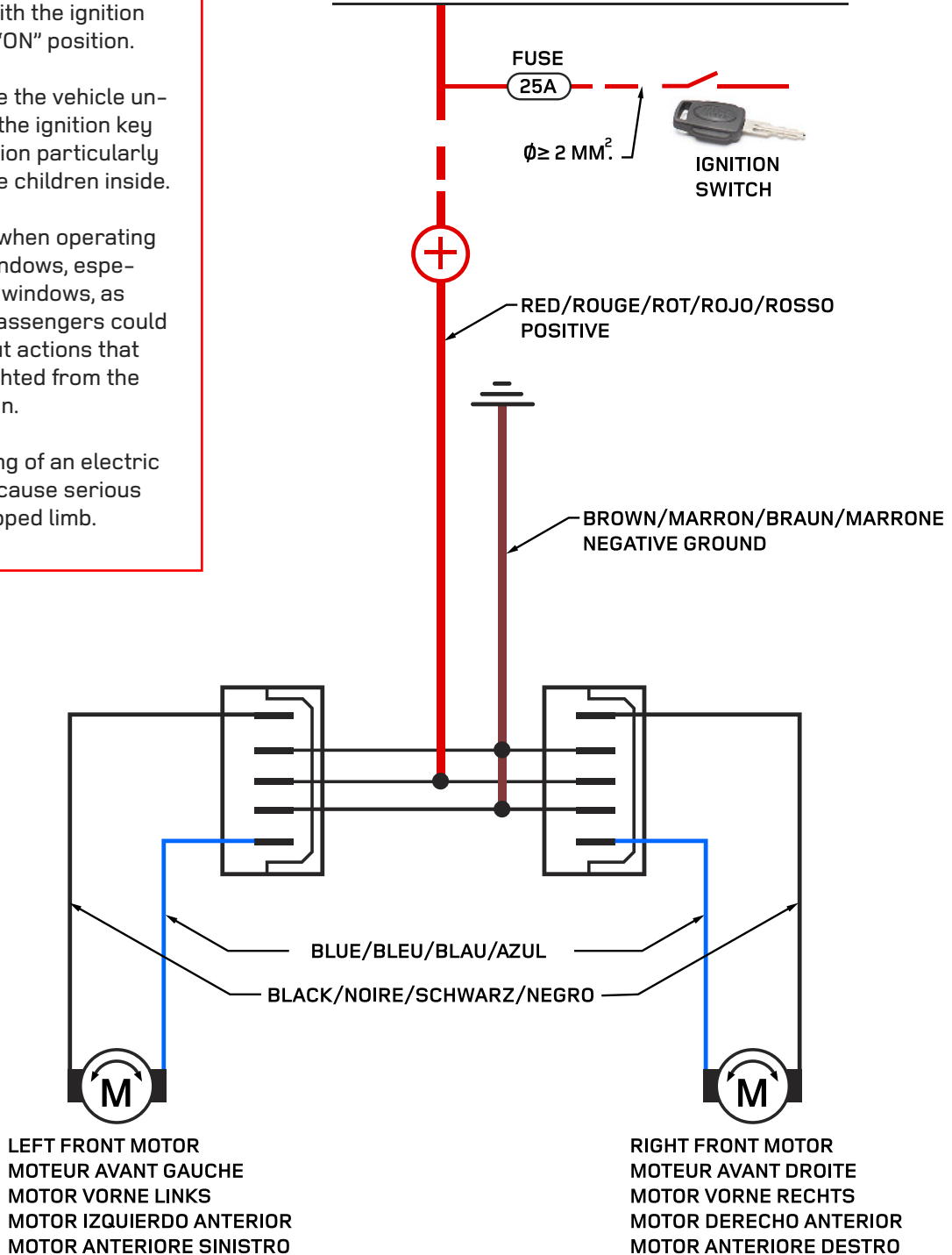

Wiring Diagram