

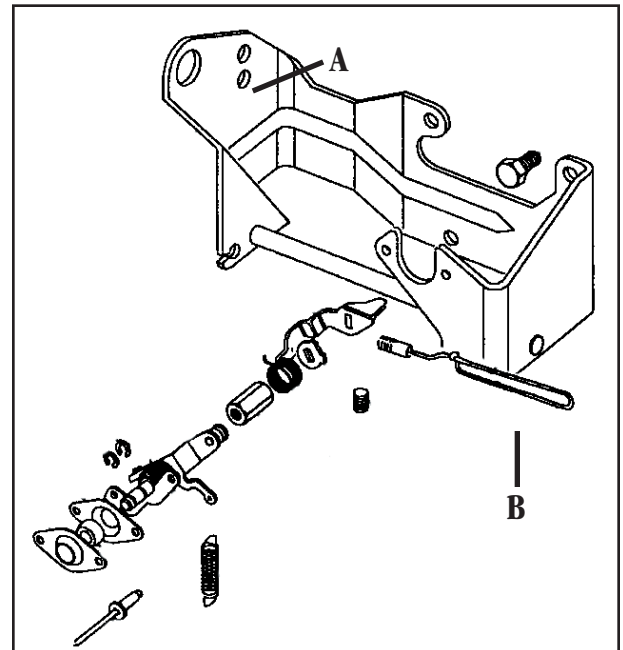

T H E   S P E C I A L I S T S   I N   L A N D   R O V E R S   •   U S A

## Hand Throttle Kit Defender 90/110

- 1) Obtain your radio code then disconnect battery.
- 2) Center steering wheel with the road wheels pointed straight ahead. (OPTIONAL) Remove the steering wheel (a puller may be required), then remove the upper column cover.
- 3) Remove the securing screws for the instrument panel. This is to gain access for feeding cable through.
- 4) Feed cable through the plug beside the speedo cable to the right and insert into the bracket behind the plug or the right side of the steering column.
- 5) Fit the cable stop to the upper hole beside the accelerator cable. Insert the cable and tighten screw only enough to hold the cable housing ("A" as shown in diagram below).
- 6) Attach the link to the throttle arm and attach cable ("B" as shown in diagram below).
- 7) Reconnect battery.
- 8) When setting the throttle depress the accelerator pedal and pull out cable to set.



**1 802 879-0032** or 1-800-403-7591 • Fax: (802) 879-9152  
email@roversnorth.com • www.roversnorth.com

Rovers North, Inc. • 1319 VT Rt. 128 • Westford, Vermont • 05494-9601 USA